

REAR COIL SPRING REMOVAL/INSTALLATION

B3E021428011W01

1. Remove the rear auto leveling sensor. (See [AUTO LEVELING SENSOR REMOVAL/INSTALLATION.](#))
2. Remove the rear stabilizer. (See [REAR STABILIZER REMOVAL/INSTALLATION.](#))
3. Remove in the order indicated in the table.
4. Install in the reverse order of removal.
5. Inspect the wheel alignment and adjust it if necessary.

(See [REAR WHEEL ALIGNMENT.](#))

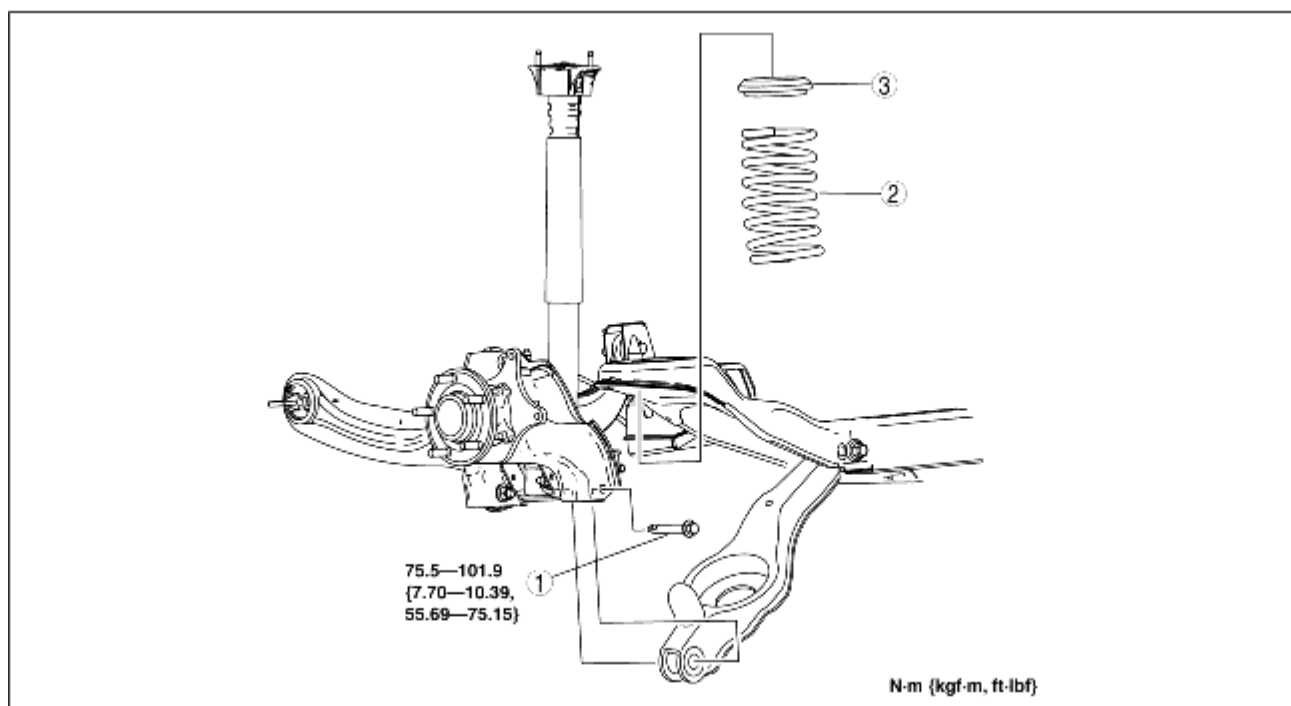

B3E0214W004

1	Rear lower arm outer bolt (See Rear Lower Arm Outer Bolt Removal Note.)
2	Rear coil spring (See Rear Coil Spring Installation Note.)
3	Upper spring seat rubber

Rear Lower Arm Outer Bolt Removal Note

1. Support the rear lower arm using a jack.

2. Loosen the rear lower arm inner bolt.
3. Remove the rear lower arm outer bolt.

Rear Coil Spring Installation Note

1. Position the jack under the rear lower arm and jack up slowly.

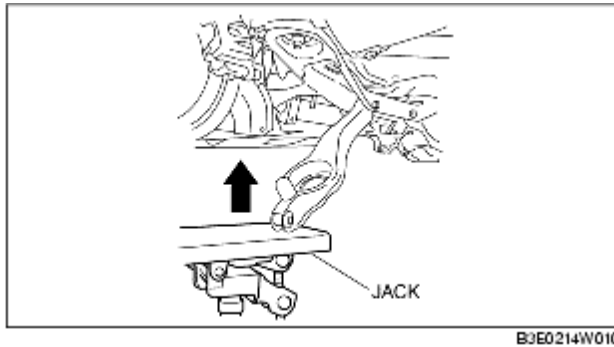

Warning

- Installing the coil spring is dangerous. The coil spring could fly off and cause serious injury or death, and damage the vehicle.

2. Align the upper end of the rear coil spring with the step of the upper spring seat rubber.
3. Align the lower end of the rear coil spring with the step of the lower spring seat rubber.
4. Install the lower arm outer bolt.